



# SILENZIATORI

AIR SILENCERS

Compressed air freely given spread in atmosphere through suitable discharges produces noise that can be reduced in a remarkable way by means of suitable devices called "air silencer".

They are made of a porous metallic body (sintered bronze - stainless steel mesh) or synthetic resins including metallic rack or other porous material. Air flow going to the discharging through these devices divides in a thin way giving a very reduced noise as result.



<b>Standard supply</b>	Thread from M5 to 1"
<b>Material</b>	AR Copper stainless steel body OT Brass CW614N body IN-NIX Stainless steel body Silencer in           Sintered bronze Stainless steel mesh Felt Sound absorbent material
<b>Pressure</b>	Max 12 bar
<b>Use Temperature</b>	-10°C +70°C
<b>Average porosity</b>	40%
<b>Filtration Threshold</b>	36 mm
<b>Use</b>	Compressed Air - Food industry
<b>Noise reduction (db)</b>	See item schedule

L'aria compressa, se fatta espandere liberamente in atmosfera attraverso gli appositi scarichi, produce rumore che può essere notevolmente ridotto per mezzo di dispositivi chiamati "Silenziatori".

Essi sono costituiti da un corpo metallico poroso (bronzo sinterizzato - rete inox) o di resine sintetiche contenenti reticelle metalliche o altro materiale poroso.

Il flusso d'aria diretto allo scarico nell'attraversare questi dispositivi, si divide finemente dando come risultato una rumorosità notevolmente ridotta.



Filettature da M5 a 1"

AR Corpo in Acciaio Ramato

OT Corpo in ottone CW641N

IN-NIX Corpo in acciaio inox

Silenziatore

Bronzo sinterizzato

Rete in acciaio Inox

Feltro

Materiale fonoassorbente

Disponibilità standard

Materiali

Max 12 bar

Pressione

-10°C +70°C

Temperatura di utilizzo

40%

Porosità media

36 mm

Soglia di filtrazione

Aria compressa - Alimentare

Impiego

Vedi tabella articolo

Abbattimento acustico  
(db)

**Silenziatore a cono corpo in acciaio ramato**  
Taper air silencer copper steel body



Code	F	CH	P	L	Gr.
SI700M5AR	M5	7	5,5	17,0	2,5
SI70018AR	1/8	12	4,5	20,5	6,0
SI70014AR	1/4	15	6,0	26,5	11,0
SI70038AR	3/8	19	7,0	33,9	23,5
SI70012AR	1/2	23	8,0	40,5	38,0
SI70034AR	3/4	30	9,0	51,5	100,0
SI7001AR	1"	36	11,0	66,0	145,0

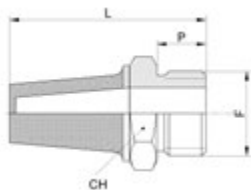

**Silenziatore a cono corpo in ottone**  
Taper air silencer brass body



Code	F	P	L	CH	Gr.
SI700M5OT	M5	4,0	17,0	8	2,0
SI70018OT	1/8	6,0	29,0	13	9,0
SI70014OT	1/4	7,0	32,0	16	15,5
SI70038OT	3/8	8,0	40,0	19	25,5
SI70012OT	1/2	9,0	45,0	24	45,5
SI70034OT	3/4	9,0	56,0	30	77,0
SI7001OT	1"	11,0	66,0	36	146,0
SI70018FOT	1/8 F	7,0	30,0	13	9,0

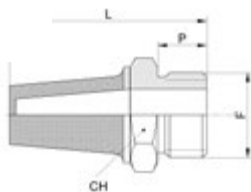

**Silenziatore a testa esagonale corpo in acciaio ramato**  
Air silencer with hexagonal head copper steel body



Code	F	Ø	P	L	CH	Gr.
SIE710M5AR	M5	8,5	5,0	20,0	8	2,0
SIE71018AR	1/8	11,5	4,5	17,5	8	6,0
SIE71014AR	1/4	15,0	6,0	24,0	10	13,0
SIE71038AR	3/8	19,0	7,0	31,0	13	25,5
SIE71012AR	1/2	23,0	8,0	37,0	14	43,0
SIE71034AR	3/4	30,0	9,0	50,0	19	79,5
SIE7101AR	1"	37,0	11,0	62,0	24	140,0

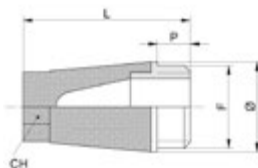

## Silenziatore a testa esagonale corpo in ottone

Air silencer with hexagonal head brass body

Code	F	Ø	P	L	CH	Gr.
SIE71018OT	1/8	12,0	6,0	21,0	7	7,5
SIE71014OT	1/4	15,0	6,0	25,0	9	12,0
SIE71038OT	3/8	19,0	8,0	36,0	19	23,0
SIE710120T	1/2	23,0	10,0	43,0	16	37,0
SIE71034OT	3/4	30,0	13,0	53,0	20	77,0
SIE71010T	1*	38,0	15,0	63,0	23	140,0

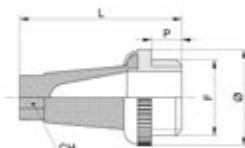

## Silenziatore a scomparsa

Extinction air silencer

Code	F	Ø	L	Gr.
SIP72018OT	1/8	6,0	4,0	1,2
SIP72014OT	1/4	8,0	4,0	3,0
SIP72038OT	3/8	10,0	5,0	6,0
SIP720120T	1/2	15,0	8,0	12,5
SIP72034OT	3/4	20,0	10,0	17,5
SIP72010T	1*	26,0	10,0	28,0



## Silenziatore a tappo con filo inox corpo in ottone

Plug air silencer with stainless steel wire brass body

Code	F	P	L	CH	Gr.
SIS73018OT	1/8	6,0	15,0	13	5,0
SIS73014OT	1/4	7,0	18,0	16	9,5
SIS73038OT	3/8	8,0	20,0	19	15,0
SIS730120T	1/2	10,0	22,0	24	25,0
SIS73034OT	3/4	10,0	26,0	30	37,0
SIS73010T	1*	12,0	28,0	36	57,0

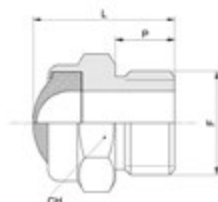

## Silenziatore a tappo corpo in ottone Plug air silencer brass body



Code	F	Ø	CH	P	L	Gr.
SIT740M5OT	M5	11,0	7	5,0	12,0	5,0
SIT74018OT	1/8	11,0	13	6,0	14,0	6,5
SIT74014OT	1/4	14,0	16	7,0	17,0	6,5
SIT74038OT	3/8	17,0	19	8,0	18,0	17,0
SIT74012OT	1/2	22,0	24	10,0	20,0	27,0
SIT74034OT	3/4	28,0	30	10,0	23,0	33,0
SIT7401OT	1"	35,0	36	12,0	25,0	42,0
SIT74018FOT	1/8 F	11,0	14	7,0	17,0	4,0

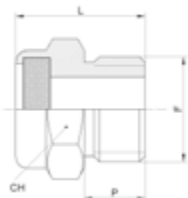

## Silenziatore a tappo corpo in ottone cilindrico Plug air silencer brass parallel body



Code	F	Ø	P	L	Gr.
SITB76018OT	1/8	15,0	6,0	12,5	6,0
SITB76014OT	1/4	16,0	8,0	13,8	9,0
SITB76038OT	3/8	30,0	9,6	16,6	14,5
SITB76012OT	1/2	36,0	10,0	18,5	25,0

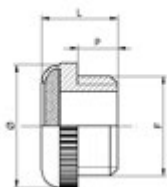

## Silenziatore a tappo corpo in acciaio inox Plug air silencer stainless steel body



Code	F	CH	P	L	dB	Gr
SIT74018NIX	1/8	14	8,0	12,0	73	
SIT74014NIX	1/4	17	8,0	12,0	74	
SIT74038NIX	3/8	22	10,0	15,0	85	
SIT74012NIX	1/2	27	12,0	19,0	89	
SIT74034NIX	3/4	32	15,0	24,0	89	
SIT7401NIX	1"	41	18,0	29,0	90	



## Regolatore di scarico silenzioso Unloading silenced regulator

Code	F	Lmin	Lmax	P	Gr.
SIM79018OT	1/8	20,0	22,0	6,0	16,5
SIM79014OT	1/4	22,0	24,0	8,0	23,5
SIM79038OT	3/8	25,0	28,0	10,0	51,0
SIM79012OT	1/2	26,0	29,0	11,0	61,0
SIM79034OT	3/4	32,0	37,0	12,0	80,0
SIM79010T	1*	32,0	37,0	12,0	103,0

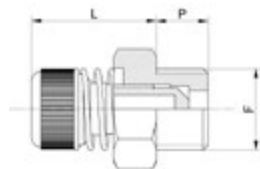

## Silenziatore in resina acetlica con materiale fonoassorbente Air silencer made of acetalic resin with sound absorbent material

Code	F	Ø	P	L	Gr.
SIPL81018	1/8	15,0	6,0	32,5	4,0
SIPL81014	1/4	19,5	8,0	43,0	7,5
SIPL81038	3/8	24,5	11,0	58,0	15,5
SIPL81012	1/2	24,5	11,0	58,0	17,0
SIPL81034	3/4	48,0	18,0	115,0	109,0
SIPL8101	1*	48,0	18,0	115,0	120,0
SIPL81018F	1/8 F	15,0	6,0	32,5	4,0

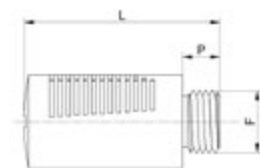

## Silenziatore in nylon con feltro Nylon air silencer with felt

Code	F	P	L	CH	Gr.
SIPF82018	1/8	6,0	34,0	10	2,5
SIPF82014	1/4	8,0	44,0	12	5,0
SIPF82038	3/8	10,0	56,0	17	10,5
SIPF82012	1/2	10,0	56,0	17	12,0
SIPF82034	3/4	18,0	115,0	-	66,5
SIPF8201	1*	18,0	115,0	-	82,0

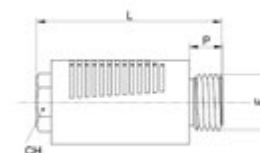









# RUBINETTI E ATTACCHI RAPIDI

AUTOMATIC QUICK COUPLINGS



Attacco europeo  
European quick coupling

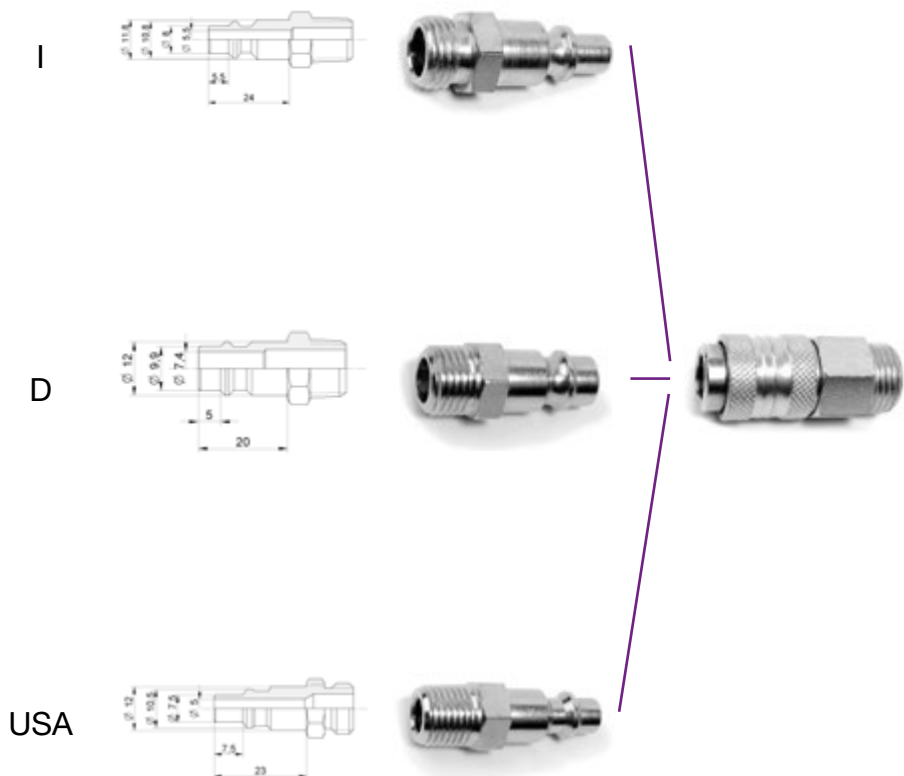

Attacco mignon  
Mignon quick coupling



This kind of fittings allow to disconnect in a simple and quick way tube of the main installation without stopping the compressed air.

The range is composed of the Universal series which allow to connect the coupling (called universal) to 3 typologies of couplings with Italian - USA - German profile and Mignon series to use when you find reduced capacity and bulks if necessary. Every profile is manufactured according standard international sizes in order to be interchangeable in every moment.



<b>Standard supply</b>	See item schedule
<b>Material</b>	Nickel plated brass CW614 / Zinc plated steel body Nickel plated brass CW614 / Zinc plated steel ferrule Nickel plated brass CW614 / Zinc plated steel cylinder Nickel plated brass CW614 / Zinc plated steel valve Stainless steel ball NBR 70 Shore O-ring Stainless steel spring
<b>Pressure</b>	Max 12 bar
<b>Use Temperature</b>	-10°C +80°C
<b>Use</b>	Compressed Air
<b>Note</b>	The references marked by * are in Nickel plated brass

I raccordi appartenenti a questa categoria consentono di scollegare in modo semplice e rapido la tubazione dall'impianto principale senza dover interrompere il flusso d'aria compressa dalla fonte d'origine.

La gamma è composta dalla serie Universale che permette di collegare all'unico rubinetto (chiamato appunto universale) le 3 tipologie di innesti con profili Italia - Usa - Tedesco e dalla serie Mignon da utilizzare dove esistono necessità di ingombri e/o portate ridotte.

Ogni profilo è prodotto secondo le misure standard internazionali al fine di essere intercambiabile in qualsiasi momento.



Vedi tabella articolo

Disponibilità standard

Corpo in ottone nichelato CW614 / acciaio zincato  
 Ghiera in ottone nichelato CW614 / acciaio zincato  
 Cilindretto in ottone nichelato CW614 / acciaio zincato  
 Valvola in ottone nichelato CW614 / acciaio zincato  
 Sfere in acciaio Inox  
 O-ring in NBR 70 Shore  
 Molle in acciaio Inox

**Materiali**

Max 12 bar

**Pressione**

-10°C +80°C

**Temperatura di utilizzo**

Aria compressa

**Impiego**

I codici contrassegnati con \* sono in ottone nichelato

**Note**

## Baionetta portagomma

### Bayonet for rubber hose



Code	Ø	CH	L	Gr.
010614NI	6x14	15	41,0	36,0
010716NI	7x16	15	41,0	39,0
010817NI	8x17	15	43,0	46,0
0101017NI	10x17	15	43,0	49,0
0101019NI	10x19	15	45,0	62,0

## Maschio portagomma

### Male for rubber hose



Code	F	Ø	CH	L	Gr.
01114614NI	1/4	6x14	15	40,0	36,0
01114716NI	1/4	7x16	15	40,0	40,0
01114817NI	1/4	8x17	15	41,0	48,0
011141017NI	1/4	10x17	15	43,0	50,0
011141019NI	1/4	10x19	15	45,0	56,0
01138614NI	3/8	6x14	19	41,0	38,0
01138716NI	3/8	7x16	19	41,0	44,0
01138817NI	3/8	8x17	19	42,0	50,0
011381017NI	3/8	10x17	19	44,0	52,0
011381019NI	3/8	10x19	19	46,0	58,0

## Femmina portagomma

### Female for rubber hose



Code	F	Ø	CH	L	Gr.
01214614NI	1/4	6x14	14	40,0	32,0
01214716NI	1/4	7x16	14	40,0	36,0
01214817NI	1/4	8x17	14	42,0	43,0
012141017NI	1/4	10x17	14	44,0	43,0
012141019NI	1/4	10x19	14	45,0	50,0
01238614NI	3/8	6x14	17	41,0	36,0
01238716NI	3/8	7x16	17	41,0	41,0
01238817NI	3/8	8x17	17	42,0	48,0
012381017NI	3/8	10x17	17	44,0	48,0
012381019NI	3/8	10x19	17	48,0	55,0



### Maschio con dado capettato

Male with milled nut

Code	F	CH	L	Gr.
01914NI	1/4	14	35,0	28,0
01938NI	3/8	17	32,0	32,0



### Femmina con dado capettato

Female with milled nut

Code	F	CH	L	Gr.
02014NI	1/4	15	33,0	36,0
02038NI	3/8	19	34,0	35,0



### Doppio dado capettato

Double milled nut

Code	F	CH	L	Gr.
02114NI	1/4	14	40,0	43,5



### T con dadi capettati

Tee with milled nuts



Code	F
02214NI	1/4

### Dado capettato

Milled nut



Code	F
02314NI	1/4
02338NI	3/8

### Rubinetto di spurgo

Male drain cock



Code	F
02518NI	1/8
02514NI	1/4
02538NI	3/8

## Maschio a baionetta Male bayonet

Code	F	CH	L
02618NI	1/8	15	23,0
02614NI	1/4	15	23,5
02638NI	3/8	17	24



## Femmina a baionetta Female bayonet

Code	F	CH	L
02718NI	1/8	10	22
02714NI	1/4	15	23,0
02738NI	3/8	19	25



## Guarnizione per baionetta Seal bayonet

Code	F
028	1/4



**Pistola di soffiaggio con raccordo**  
Blow gun with fitting



Code  
029

F  
1/4

**Pistola di soffiaggio senza raccordo**  
Blow gun without fitting



Code  
029SR

F  
1/4

**Pistola di soffiaggio con prolunga**  
Blow gun with extension



Code  
030

F  
1/4

### Raccordo diritto con attacco a baionetta + dado con molla

Compression straight fitting with bayonet connection + nut with spring

Code	Ø
061F86NI	8X6
061F108NI	10X8



### Raccordo diritto girevole con attacco a baionetta + dado con molla

Swivel compression fittings with bayonet connection + nut with spring

Code	Ø
061G86NI	8X6
061G108NI	10X8



### Rubinetto maschio mignon Male mignon cock



Code	F
500M18NI*	1/8
500M14NI*	1/4

### Rubinetto maschio universale Universal male cock



Code	F
500U14TNI	1/4
500U38TNI	3/8
500U12TNI	1/2
500U14OTNI*	1/4
500U38OTNI*	3/8
500U12OTNI*	1/2

### Rubinetto femmina mignon Female mignon cock



Code	F
501M18NI*	1/8
501M14NI*	1/4

## Rubinetto femmina universale Universal female cock

Code	F
501U14TNI	1/4
501U38TNI	3/8
501U12TNI	1/2
501U14OTNI*	1/4
501U38OTNI*	3/8



## Rubinetto con portatubo mignon Mignon cock for rubber hose

Code	Ø
502M614NI*	6x14
502M817NI*	8x17



## Rubinetto portatubo universale Universal cock for rubber hose

Code	Ø
502U614TNI	6x14
502U817TNI	8x17
502U614OTNI*	6x14
502U817OTNI*	8x17



### Rubinetto con molla mignon Mignon cock with spring



Code	Ø
503M64NI*	6x4
503M86NI*	8x6

### Rubinetto con molla universale Universal cock with spring



Code	Ø
503U86TNI	8x6
503U108TNI	10x8
503U86OTNI*	8x6
503U108OTNI*	10x8

### Rubinetto a resca mignon Mignon cock with rest



Code	Ø
504M6NI*	6
504M8NI	8
504M9NI*	9



## Rubinetto a resca universale Universal cock with rest

Code	Ø
504U6TNI	6
504U7TNI	7
504U8TNI	8
504U9TNI	9
504U10TNI	10
504U11TNI	11
504U12TNI	12
504U13TNI	13
504U6OTNI*	6
504U8OTNI*	8
504U10OTNI*	10
504U12OTNI*	12



## Rubinetto a calzamento mignon Mignon adapter cock

Code	Ø
505M64NI*	6x4
505M86NI*	8x6



## Innesto portatubo Plug for rubber hose

Code	Ø
513I614NI	6x14
513I716NI	7x16
513I817NI	8x17
513I1017NI	10x17
513I1019NI	10x19



## Innesto portatubo mignon

Mignon plug for rubber hose



Code	Ø
513M614NI*	6x14
513M817NI*	8x17

## Innesto maschio I

I male plug



Code	F
514I14NI	1/4
514I38NI	3/8

## Innesto maschio D

D male plug



Code	F
514D14NI	1/4
514D38NI	3/8

## Innesto maschio USA USA male plug

Code	F
514A14NI	1/4
514A38NI	3/8



## Innesto maschio mignon Male mignon plug

Code	F
514M18NI	1/8
514M14NI	1/4



## Innesto femmina I I female plug

Code	F
515I14NI	1/4
515I38NI	3/8



### Innesto femmina D D female plug



Code	F
515D14NI	1/4
515D38NI	3/8

### Innesto femmina USA USA female plug



Code	F
515A14NI	1/4
515A38NI	3/8

### Innesto femmina mignon Mignon female plug



Code	F
515M18NI*	1/8
515M14NI*	1/4

## Innesto a baionetta I I bayonet plug

Code	L
516IN	36



## Innesto a resca D D plug with rest

Code	Ø
524D6NI	6
524D7NI	7
524D8NI	8
524D9NI	9
524D10NI	10
524D12NI	12



## Innesto a resca USA USA plug with rest

Code	Ø
524A6NI	6
524A8NI	8
524A10NI	10



### Innesto a resca mignon Mignon plug with rest



Code	Ø
524M6NI*	6
524M8NI	8
524M9NI*	9

### Innesto a calzamento mignon Mignon adapter plug



Code	Ø
530M64NI*	6x4
530M86NI*	8x6

### Innesto maschio con molla I I male plug with spring



Code	Ø
563I86NI	8x6
563I108NI	10x8

**Innesto maschio con molla USA**  
USA male plug with spring

Code	Ø
563A86NI	8x6
563A108NI	10x8



**Innesto maschio con molla mignon**  
Mignon male plug with spring

Code	Ø
563M64NI	6x4
563M86NI	8x6







# TUBI IN PLASTICA E SPIRALI

PLASTIC TUBES AND SPIRALS

**Tubo in Poliuretano: blu**  
Polyurethane hose: blue



Code	Ø1	Ø2	PU	PS	R	Q.tà
TUPO42B	4,0	2,0	15	60	11	100 mt
TUPO425B	4,0	2,5	10	40	15	100 mt
TUPO64B	6,0	4,0	10	40	18	100 mt
TUPO86B	8,0	6,0	7	28	35	100 mt
TUPO108B	10,0	8,0	5,5	22	43	100 mt
TUPO129B	12,0	9,0	6	25	50	100 mt

**Allungamento alla rottura / Extension to the breakup :** 500%  
**Temperatura di utilizzo / Use temperature :** -40°C / + 60 °C  
**Norme / Norms :** DIN53453 - DIN EN ISO 159  
**Pressione di utilizzo / Use pressure :** PU ( bar 23°C)  
**Pressione di scoppio / Burst pressure :** PS ( bar 23°C)  
**Raggio di curva / Ray of curve :** R ( mm 23°C)  
**Colori disponibili / Available colors :** Nero/Black , Giallo/Yellow , Rosso/Red , Verde / Green

**Tubo in Polietilene: azzurro**  
Polyethylene hose: light blue



Code	Ø1	Ø2	PU	PS	R	Q.tà
TUPE42A	4,0	2,0	18,5	75	20	100 mt
TUPE64A	6,0	4,0	10	70	40	100 mt
TUPE86A	8,0	6,0	7,5	30	50	100 mt
TUPE108A	10,0	8,0	6	25	120	100 mt

**Allungamento alla rottura / Extension to the breakup :** 400%  
**Temperatura di utilizzo / Use temperature :** -20°C / + 60 °C  
**Norme / Norms :** D.M. 21/03/73 suc. - FDA21 CFR177.1520- Farmacopea Europea - Direttiva 2002/72/CEE D.M. n° 174 del 06/04/04  
**Pressione di utilizzo / Use pressure :** PU ( bar 23°C)  
**Pressione di scoppio / Burst pressure :** PS ( bar 23°C)  
**Raggio di curva / Ray of curve :** R ( mm 23°C)  
**Colori disponibili / Available colors :** Nero/Black , Blu/Blue , Giallo/Yellow , Rosso/Red , Verde / Green

**Tubo in Rilsan PA12: azzurro**  
Rilsan PA12 hose: light blue



Code	Ø1	Ø2	PU	PS	R	Q.tà
TURIL1242A	4	2	44	130	15	100 mt
TURIL12425A	4	2,5	36	108	20	100 mt
TURIL1264A	6	4	27	81	30	100 mt
TURIL1286A	8	6	20	60	40	100 mt
TURIL12108A	10	8	15	45	60	100 mt
TURIL121210A	12	10	13	39	85	100 mt

**Allungamento alla rottura / Extension to the breakup :** >300%  
**Temperatura di utilizzo / Use temperature :** -40°C / + 70 °C  
**Norme / Norms :** ISO 1874 - DIN 73378  
**Pressione di utilizzo / Use pressure :** PU ( bar 23°C)  
**Pressione di scoppio / Burst pressure :** PS ( bar 23°C)  
**Raggio di curva / Ray of curve :** R ( mm 23°C)  
**Colori disponibili / Available colors :** Nero/Black , Blu/Blue , Giallo/Yellow , Rosso/Red , Verde / Green

**Spirale in Poliuretano 95ShA: blu**  
Polyurethane spiral hose 95ShA: blue

Code	Ø1	Ø2	ØD	L	PU	PS	Q.tà
SPP08555B	8	5,5	30	5,0m	9	36	1pz
SPP085510B	8	5,5	30	10,0m	9	36	1pz
SPP010655B	10	6,5	40	5,0m	7	28	1pz
SPP0106510B	10	6,5	40	10,0m	7	28	1pz



Allungamento alla rottura / Extension to the breakup : 550%  
 Temperatura di utilizzo / Use temperature : -40°C / + 60 °C  
 Norme / Norms : DIN53453 - DIN EN ISO 159  
 Pressione di utilizzo / Use pressure : PU ( bar 23°C)  
 Pressione di scoppio / Burst pressure : PS ( bar 23°C)  
 Colori disponibili / Available colors : Giallo/Yellow

**Spirale in Poliuretano 98ShA: blu**  
Polyurethane spiral hose 98ShA: blue

Code	Ø1	Ø2	ØD	L	PU	PS	Q.tà
SSPOF855B	8	5	40	5,0m	13	52	1pz
SPP0F8510B	8	5	40	10,0m	13	52	1pz
SPP0F106510B	10	6,5	40	10,0m	10	40	1pz



Allungamento alla rottura / Extension to the breakup : 500%  
 Temperatura di utilizzo / Use temperature : -40°C / + 60 °C  
 Norme / Norms : DIN53453 - DIN EN ISO 159  
 Pressione di utilizzo / Use pressure : PU ( bar 23°C)  
 Pressione di scoppio / Burst pressure : PS ( bar 23°C)  
 Colori disponibili / Available colors : -

**Spirale in Rilsan PA12: blu**  
Rilsan PA12 spiral hose: blue

Code	Ø1	Ø2	Ø	L	PU	PS	Q.tà
SPRIL126430B	6	4	50	30,0m	27	81	1pz
SPRIL128615B	8	6	70	15,0m	20	60	1pz
SPRIL128630B	8	6	70	30,0m	20	60	1pz
SPRIL1210815B	10	8	85	15,0m	15	45	1pz
SPRIL1210830B	10	8	85	30,0m	15	45	1pz



Allungamento alla rottura / Extension to the breakup : 500%  
 Temperatura di utilizzo / Use temperature : -40°C / + 60 °C  
 Norme / Norms : DIN53453 - DIN EN ISO 159  
 Pressione di utilizzo / Use pressure : PU ( bar 23°C)  
 Pressione di scoppio / Burst pressure : PS ( bar 23°C)  
 Colori disponibili / Available colors : Arancio/Orange

## Staffa fissatubo Hose clamp



Code	Ø	POS	Q.tà
STF4	4	10	10 pz
STF6	6	10	10 pz
STF8	8	10	10 pz
STF10	10	10	10 pz
STF12	12	4	10 pz
STF14	14	4	10 pz







# RACCORDI AUTOMATICI INOX

STAINLESS STEEL PUSH-IN FITTINGS

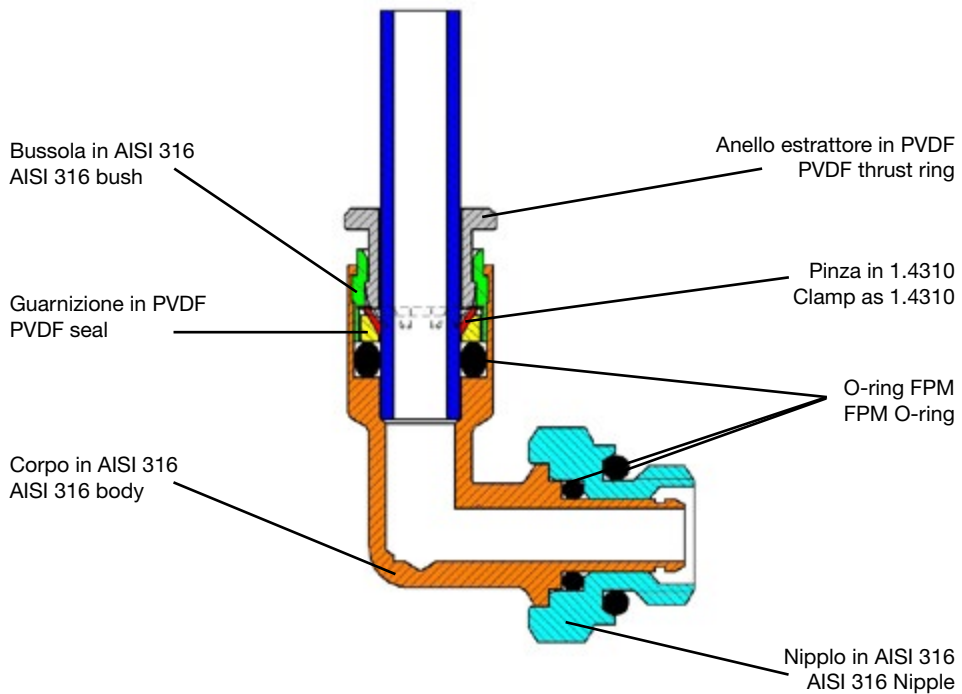



<b>Disponibilità standard</b>	Ø Tubo da 4 a 12 mm filetto da M5 a 1/2"	
<b>Materiali</b>	vedi disegno	
<b>Temperatura di utilizzo</b>	-20°C +120°C	
<b>Filettature</b>	Gas Coniche Gas Cilindriche Metriche	Iso 7.1 Din 2999 Iso 228 classe A Iso R/262
<b>Impiego</b>	Alimentare - Chimico	
<b>Tubazioni</b>	Nylon - PA11- PA12 - poliuretano Polietilene	
<b>Opzioni</b>	-	

<b>Standard supply</b>	Ø Tube from 4 to 12 mm Thread from M5 to 1/2"	
<b>Material</b>	See drawing	
<b>Use temperature</b>	-20°C +120°C	
<b>Thread</b>	Taper Gas Parallel Gas Metric	Iso 7.1 Din 2999 Iso 228 A category Iso R/262
<b>Use</b>	Food and Chemical Industry	
<b>Tube</b>	Nylon - PA11- PA12 - Polyurethane Polyethylene	
<b>Options</b>	-	

**Raccordo diritto maschio cilindrico con OR**  
**Straight male adapter (parallel) with O-ring**



Code	Ø	F	P	L
UR01M54NIX	4	M5	3,5	16,5
UR01184NIX	4	1/8	5	14
UR01M56NIX	6	M5	3,5	17,5
UR01186NIX	6	1/8	5	15
UR01146NIX	6	1/4	7	14,5
UR01188NIX	8	1/8	5	20
UR01148NIX	8	1/4	7	16
UR01388NIX	8	3/8	8	16
UR011410NIX	10	1/4	7	22
UR013810NIX	10	3/8	8	17,5
UR011210NIX	10	1/2	9	15,5
UR011412NIX	12	1/4	7	25
UR013812NIX	12	3/8	8	19,5

**Raccordo diritto maschio conico**  
**Straight male adapter (taper)**



Code	Ø	F	P	L
UR01K184NIX	4	1/8	7,5	20,5
UR01K186NIX	6	1/8	7,5	21,5
UR01K146NIX	6	1/4	11,0	24,5
UR01K188NIX	8	1/8	7,5	27,0
UR01K148NIX	8	1/4	11,0	26,5
UR01K388NIX	8	3/8	11,5	24,5
UR01K1410NIX	10	1/4	11,0	32,5
UR01K3810NIX	10	3/8	11,5	28,0
UR01K1210NIX	10	1/2	14,0	26,5
UR01K1212NIX	12	1/2	14,0	31,5

## Raccordo a gomito intermedio Elbow connector

Code	Ø	Ø1	L	L1	CH
UR044NIX	4	4	22	22	10
UR046NIX	6	6	23,5	23,5	10
UR048NIX	8	8	27,5	27,5	13
UR0410NIX	10	10	29,5	29,5	13
UR0412NIX	12	12	32	32	17



## Raccordo a T intermedio Tee connector

Code	Ø	L	CH
UR054NIX	4	22	10
UR056NIX	6	23,5	10
UR058NIX	8	27,5	13
UR0510NIX	10	29,5	13
UR0512NIX	12	32	17



## Adattatore cilindrico con OR

### Parallel adapter (short) with O-ring



Code	Ø	F	P	L	CH
UR06184NIX	4	1/8	5	21,5	13
UR06144NIX	4	1/4	7	22	17
UR06186NIX	6	1/8	5	22,5	13
UR06146NIX	6	1/4	7	23	17
UR06188NIX	8	1/8	5	24,5	13
UR06148NIX	8	1/4	7	25	17
UR061410NIX	10	1/4	7	29	17
UR063810NIX	10	3/8	8	29	19
UR063812NIX	12	3/8	8	31	19

## Raccordo a gomito fisso conico

### Elbow male adapter (taper)



Code	Ø	F	P	L	L1	CH
UR19184NIX	4	1/8	9	22	18,5	10
UR19186NIX	6	1/8	9	23,5	18,5	10
UR19146NIX	6	1/4	10,5	23,5	21	10
UR19188NIX	8	1/8	8,5	27,5	18,5	13
UR19148NIX	8	1/4	10,5	27,5	23	13
UR19388NIX	8	3/8	11	27,5	24,5	13
UR191410NIX	10	1/4	10,5	29,5	23	13
UR193810NIX	10	3/8	11	29,5	24,5	13
UR193812NIX	12	3/8	11	32	24,5	17

**Raccordo a T girevole centrale con OR**  
Swivel tee parallel central adapter with O-ring

Code	Ø	F	P	L	L1	CH	CH1
UR20184NIX	4	1/8	5	22	15	10	13
UR20186NIX	6	1/8	5	23,5	15	10	13
UR20146NIX	6	1/4	7	23,5	15,5	10	17
UR20188NIX	8	1/8	5	27,5	16,5	13	13
UR20148NIX	8	1/4	7	27,5	17,5	13	17
UR20388NIX	8	3/8	8	27,5	19,5	13	19
UR201410NIX	10	1/4	7	29,5	17,5	13	17
UR203810NIX	10	3/8	8	29,5	19,5	13	19
UR203812NIX	12	3/8	8	32	19,5	17	19



**Raccordo a gomito cilindrico maschio con OR**  
Elbow male parallel adapter with O-ring

Code	Ø	F	P	L	L1	CH	CH1
UR22184NIX	4	1/8	5	22	15	10	13
UR22186NIX	6	1/8	5	23,5	15	10	13
UR22146NIX	6	1/4	7	23,5	15,5	10	17
UR22188NIX	8	1/8	5	27,5	16,5	13	13
UR22148NIX	8	1/4	7	27,5	17,5	13	17
UR22388NIX	8	3/8	8	27,5	19,5	13	19
UR221410NIX	10	1/4	7	29,5	17,5	13	17
UR223810NIX	10	3/8	8	29,5	19,5	13	19
UR221412NIX	12	1/4	7	32	18,5	17	17
UR223812NIX	12	3/8	8	32	19,5	17	19



**Raccordo a T maschio centrale conico**  
**Tee male adapter central leg (taper)**



Code	Ø	F	P	L	L1	CH
UR26184NIX	4	1/8	9	22	18,5	10
UR26186NIX	6	1/8	9	23,5	18,5	10
UR26146NIX	6	1/4	10,5	23,5	21	10
UR26188NIX	8	1/8	8,5	27,5	18,5	13
UR26148NIX	8	1/4	10,5	27,5	23	13
UR26388NIX	8	3/8	11	27,5	24,5	13
UR261410NIX	10	1/4	10,5	29,5	23	13
UR263810NIX	10	3/8	11	29,5	24,5	13
UR263812NIX	12	3/8	11	32	24,5	17









**RACCORDI  
AUTOMATICI PVDF**

PVDF PUSH-IN FITTINGS

Bussola in AISI 316  
AISI 316 bush

Guarnizione in PVDF  
PVDF seal

Corpo in PVDF  
PVDF body

Anello estrattore in PVDF  
PVDF thrust ring

Pinza in 1.4310  
Clamp as 1.4310

O-ring FPM  
FPM O-ring

Nipplo in AISI 316  
AISI 316 Nipple

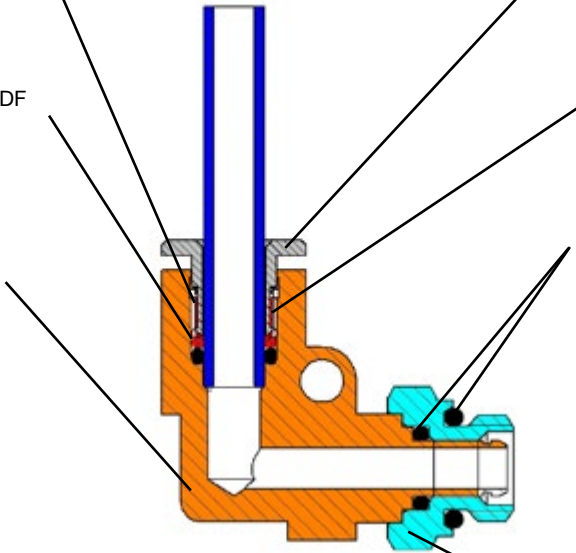

<b>Disponibilità standard</b>	Ø Tubo da 4 a 12 mm filetto da M5 a 3/8"	
<b>Materiali</b>	vedi disegno	
<b>Temperatura di utilizzo</b>	Ambiente	-20°C + 60°C
	Fluidi	-20°C + 120°C
<b>Pressione di Utilizzo</b>	16 bar / Max Temp. 20°C 10 bar / Max Temp. 100°C 3 bar / Max Temp. 120°C	
<b>Filettature</b>	Gas Cilindriche	Iso 228 classe A
<b>Impiego</b>	Alimentare - Industria Chimica e Medica Trattamento Acqua	
<b>Tubazioni</b>	Nylon - PA11- PA12 - poliuretano Polietilene	
<b>Opzioni</b>	-	

<b>Standard supply</b>	Ø Tube from 4 to 12 mm Thread from M5 to 3/8"	
<b>Material</b>	See drawing	
<b>Use temperature</b>	Room	-20°C + 60°C
	Fluid	-20°C + 120°C
<b>Use Pressure range</b>	16 bar / Max Temp. 20°C 10 bar / Max Temp. 100°C 3 bar / Max Temp. 120°C	
<b>Thread</b>	Parallel Gas	Iso 228 A category
<b>Use</b>	Food, Chemical and Medical Industry, Water Treatment	
<b>Tube</b>	Nylon - PA11- PA12 - Polyurethane Polyethylene	
<b>Options</b>	-	

## Raccordo diritto intermedio Straight connector



Code	Ø	Ø1	L
UR034PVDF	4	-	31,0
UR036PVDF	6	-	32,0
UR038PVDF	8	-	36,0
UR0310PVDF	10	-	41,0
UR0312PVDF	12	-	46,0
UR0346PVDF	4	6	31,5
UR0368PVDF	6	8	35,5
UR03810PVDF	8	10	40,5

## Raccordo a gomito intermedio Elbow connector



Code	Ø	Ø1	L	L1
UR044PVDF	4	4	18,3	18,5
UR046PVDF	6	6	19,0	19,0
UR048PVDF	8	8	22,0	22,0
UR0410PVDF	10	10	26,0	26,0
UR0412PVDF	12	12	31,0	31,0
UR0446PVDF	4	6	19,0	18,5
UR0468PVDF	6	8	22,0	21,5
UR04810PVDF	8	10	26,0	25,5

## Raccordo a T intermedio Tee connector

Code	Ø	Ø1	L
UR054PVDF	4	-	18,5
UR056PVDF	6	-	19,5
UR058PVDF	8	-	22,0
UR0510PVDF	10	-	26,0
UR0512PVDF	12	-	31,0
UR0546PVDF	4	6	19,0
UR0568PVDF	6	8	22,0
UR05810PVDF	8	10	28,0



## Raccordo a T girevole centrale con OR Swivel tee parallel central adapter with O-ring

Code	Ø	F	P	L	L1	CH
UR20184PVDF	4	1/8	5	18,5	19,5	13
UR20144PVDF	4	1/4	7	18,5	20,0	17
UR20186PVDF	6	1/8	5	19,0	19,5	13
UR20146PVDF	6	1/4	7	19,0	20,0	17
UR20188PVDF	8	1/8	5	22,0	22,0	14
UR20148PVDF	8	1/4	7	22,0	22,5	17
UR201388PVDF	8	3/8	8	22,0	22,5	19
UR201410PVDF	10	1/4	7	26,0	25,5	17
UR203810PVDF	10	3/8	8	26,0	25,5	19
UR201412PVDF	12	1/4	7	31,0	30,5	17
UR203812PVDF	12	3/8	8	31,0	30,5	19



## Raccordo a gomito cilindrico maschio con OR

### Elbow male parallel adapter with O-ring



Code	Ø	F	P	L	L1	CH1
UR22M54PVDF	4	M5	3,5	17,0	9,0	8
UR22184PVDF	4	1/8	5	18,5	19,5	13
UR22144PVDF	4	1/4	7	18,5	20,0	17
UR22M56PVDF	6	M5	3,5	18,0	10,0	8
UR22186PVDF	6	1/8	5	19,0	19,5	13
UR22146PVDF	6	1/4	7	19,0	20,0	17
UR22188PVDF	8	1/8	5	22,0	22,0	14
UR22148PVDF	8	1/4	7	22,0	22,5	17
UR22388PVDF	8	3/8	8	22,0	22M5	19
UR221410PVDF	10	1/4	7	26,0	25,5	17
UR223810PVDF	10	3/8	8	26,0	25,5	19
UR221412PVDF	12	1/4	8	31,0	30,5	17
UR223812PVDF	12	3/8	8	31,0	30,5	19







A close-up photograph of several stainless steel fittings, likely made of 316L stainless steel, arranged on a dark background. The fittings are L-shaped and have a hexagonal base with a threaded end. One fitting in the center has the number '316' engraved on its side. The lighting highlights the metallic texture and the precision of the manufacturing.

# RACCORDI CALZAMENTO INOX

STAINLESS STEEL TOUCH FITTINGS

Touch fittings are mainly used during “plastic” tubes assembly especially in case of vibrations or extreme climatic conditions (that involve changes on tube features by passing time). The fitting tube connection takes place through the clamping of a metal ring which makes it safe and reliable during time.



Standard supply	Ø Tube from 6/4 to 12/10 mm Thread from 1/8 to 1/2"	
Material	Stainless steel body and nut Viton Seal Stainless steel seeger	
Pressure	Max 25 bar	
Use Temperature	-40°C + 180°C -20°C + 120°C ( Swivel Fittings )	
Thread	Taper gas	Iso 7.1 Din 2999
	Parallel gas	Iso 228 classe A
	Metric	Iso R/262
Use	Compressed air - Food industry - Chemical - Medical industry	
Tube	Nylon PA6 - PA11 - PA12 - Polyethylene - Polyurethane - Teflon	
	Tolerances	Ø 4÷8                      Øext.±0,1 Ø 10÷24   Øext.±0,15
Options	-	

I raccordi a calzamento sono particolarmente adatti negli assemblaggi di tubi "plastici", in particolar modo dove possano esserci vibrazioni o condizioni climatiche estreme (che comportano nel tempo mutamenti alle caratteristiche del tubo). L'aggancio del tubo al raccordo avviene infatti attraverso il serraggio di una ghiera che lo rende sicuro e affidabile nel tempo.



Disponibilità standard	Ø Tubo da 6/4 a 12/10 mm filettature da 1/8 a 1/2"	
Materiali	Corpo e Dado in Inox 316 Guarnizione in Viton Seeger in Acciaio Inox	
Pressione	Max 25 bar	
Temperatura di utilizzo	-40°C +180°C -20°C + 120°C ( Raccordi Girevoli )	
Filettature	Gas Coniche	Iso 7.1 Din 2999
	Gas Cilindriche	Iso 228 classe A
	Metriche	Iso R/262
Impiego	Aria compressa - Alimentare - Chimico - Medicale	
Tubazioni	Nylon PA6 - PA11 - PA12 - Polietilene - Poliuretano - Teflon	
	Tolleranze	Ø 4÷8    Ø            est.±0,1 Ø 10÷24    Øest.±0,15
Opzioni	-	

**Raccordo diritto maschio conico**  
**Straight male adapter (taper)**



Code	Ø	F	P	L	CH	CH1
D1511864NIX	6/4	1/8	7,5	26,0	12	12
D1511464NIX	6/4	1/4	11,0	30,0	14	12
D1511886NIX	8/6	1/8	7,5	26,0	12	14
D1511486NIX	8/6	1/4	11,0	30,0	14	14
D1513886NIX	8/6	3/8	11,0	32,0	17	14
D15118108NIX	10/8	1/8	7,5	28,0	14	17
D15114108NIX	10/8	1/4	11,0	32,0	14	17
D15138108NIX	10/8	3/8	11,0	32,0	17	17
D151381210NIX	12/10	3/8	11,5	34,0	17	19
D151121210NIX	12/10	1/2	14,0	37,0	22	19

**Raccordo diritto maschio cilindrico**  
**Straight male adapter (parallel)**



Code	Ø	F	P	L	CH	CH1
D15131864NIX	6/4	1/8	8,0	18,5	13	12
D15131464NIX	6/4	1/4	10,0	19,0	17	12
D15131886NIX	8/6	1/8	8,0	18,5	13	14
D15131486NIX	8/6	1/4	10,0	19,0	17	14
D15133886NIX	8/6	3/8	10,0	20,5	19	14
D151318108NIX	10/8	1/8	8,0	20,0	14	17
D151314108NIX	10/8	1/4	10,0	20,5	17	17
D151338108NIX	10/8	3/8	10,0	20,5	19	17
D1513381210NIX	12/10	3/8	10,0	22,0	19	19
D1513121210NIX	12/10	1/2	12,0	22,5	24	19

## Raccordo a L maschio conico Elbow male adapter (taper)

Code	Ø	F	P	L	L1	CH	CH1
C1501864NIX	6/4	1/8	9,0	18,5	22,5	11	12
C1501464NIX	6/4	1/4	11,0	21,0	22,5	11	12
C1501886NIX	8/6	1/8	9,0	18,5	22,5	11	14
C1501486NIX	8/6	1/4	11,0	21,0	22,5	11	14
C1503886NIX	8/6	3/8	11,5	25,0	26,5	14	14
C15018108NIX	10/8	1/8	9,0	18,5	25,0	11	17
C15014108NIX	10/8	1/4	11,0	21,0	25,0	11	17
C15038108NIX	10/8	3/8	11,5	25,0	27,0	14	17
C150381210NIX	12/10	3/8	11,5	25,0	29,0	14	19
C150121210NIX	12/10	1/2	14,0	29,0	30,5	17	19



## Raccordo a L intermedio Elbow connector

Code	Ø	L	CH	CH1
L15564NIX	6/4	22,5	11	12
L15586NIX	8/6	22,5	11	14
L155108NIX	10/8	25	11	17
L1551210NIX	12/10	29	14	19



**Raccordo a T maschio centrale conico**  
**Tee male adapter (taper) - centre leg**



Code	Ø	F	P	L	L1	CH	CH1
TC1411864NIX	6/4	1/8	9,0	18,5	22,5	11	12
TC1411464NIX	6/4	1/4	11,0	21,0	22,5	11	12
TC1411886NIX	8/6	1/8	9,0	18,5	22,5	11	14
TC1411486NIX	8/6	1/4	11,0	21,0	22,5	11	14
TC14118108NIX	10/8	1/8	9,0	18,5	25,0	11	17
TC14114108NIX	10/8	1/4	11,0	21,0	25,0	11	17
TC14138108NIX	10/8	3/8	11,5	25,0	27,0	14	17
TC141381210NIX	12/10	3/8	11,5	25,0	29,0	14	19
TC141121210NIX	12/10	1/2	14,0	29,0	32,5	17	19

**Raccordo a T maschio laterale conico**  
**Tee male adapter (taper) - offset leg**



Code	Ø	F	P	L	L1	CH	CH1
TL1421864NIX	6/4	1/8	9,0	41,0	22,5	11	12
TL1421464NIX	6/4	1/4	10,5	43,5	22,5	11	12
TL1421886NIX	8/6	1/8	9,0	41,0	22,5	11	14
TL1421486NIX	8/6	1/4	10,5	43,5	22,5	11	14
TL14218108NIX	10/8	1/8	9,0	43,5	25,0	11	17
TL14214108NIX	10/8	1/4	10,5	46,0	25,0	11	17
TL14238108NIX	10/8	3/8	11,5	54,0	29,0	14	17

**Raccordo a T girevole maschio conico**  
Swivel tee male adapter (taper) centre leg

Code	Ø	F	P	L	L1	CH	CH1	CH2
T143G1864NIX	6/4	1/8	7,5	22,5	21,5	11	12	13
T143G1464NIX	6/4	1/4	11,0	22,5	25,5	11	12	14
T143G1886NIX	8/6	1/8	7,5	22,5	21,5	11	14	13
T143G1486NIX	8/6	1/4	11,0	22,5	25,5	11	14	14
T143G14108NIX	10/8	1/4	11,0	25,0	25,5	11	17	14



**Raccordo a T girevole maschio cilindrico**  
Swivel tee male adapter (parallel) centre leg

Code	Ø	F	P	L	L1	CH	CH1	CH2
T1433G1864NIX	6/4	1/8	8,0	22,5	14,0	11	12	13
T1433G1464NIX	6/4	1/4	10,0	22,5	14,5	11	12	17
T1433G1886NIX	8/6	1/8	8,0	22,5	14,0	11	14	13
T1433G1486NIX	8/6	1/4	10,0	22,5	14,5	11	14	17
T1433G14108NIX	10/8	1/4	10,0	23,5	14,5	11	17	17



## Raccordo a T intermedio Tee connector



Code	Ø	L	CH	CH1
TT15464NIX	6/4	22,5	11	12
TT15486NIX	8/6	22,5	11	14
TT154108NIX	10/8	25,0	11	17
TT1541210NIX	12/10	29,0	14	19

## Raccordo a L girevole maschio conico Swivel elbow male adapter (taper)



Code	Ø	F	P	L	L1	CH	CH1	CH2
C154G1864NIX	6/4	1/8	7,5	22,5	21,5	11	12	13
C154G1464NIX	6/4	1/4	11,0	22,5	25,5	11	12	17
C154G1886NIX	8/6	1/8	7,5	24	24,5	11	14	12
C154G1486NIX	8/6	1/4	11,0	22,5	25,5	11	14	17
C154G14108NIX	10/8	1/4	11,0	22,5	25,5	11	17	17



## Raccordo a L girevole maschio cilindrico

### Swivel elbow male adapter (parallel)

Code	Ø	F	P	L	L1	CH	CH1	CH2
C1543G1864NIX	6/4	1/8	8,0	22,5	14,0	11	12	13
C1543G1464NIX	6/4	1/4	10,0	22,5	14,5	11	12	17
C1543G1886NIX	8/6	1/8	8,0	22,5	14,0	11	14	13
C1543G1486NIX	8/6	1/4	10,0	22,5	14,5	11	14	17
C1543G14108NIX	10/8	1/4	10,0	23,5	14,5	11	17	17



## Dado di bloccaggio

### Locking nut

Code	Ø	F	L	CH
D17064NIX	6/4	M10x1	11,5	12
D17086NIX	8/6	M12x1	11,5	14
D170108NIX	10/8	M14x1	13,5	17
D1701210NIX	12/10	M16x1	14,5	19



## Raccordo diritto intermedio

### Straight connector



Code	Ø	Ø1	L	CH	CH1	CH2	Gr
DD15864NIX	6/4	6/4	35,0	12	12	12	22,0
DD15886NIX	8/6	8/6	37,0	12	14	14	26,0
DD158108NIX	10/8	10/8	40,0	14	16	16	37,5
DD1581210NIX	12/10	12/10	38,0	17	19	19	53,0

## Passaparete

### Bulkhead connector



Code	Ø	F	L	CH	CH1	MAX	Gr
RP15964NIX	6/4	M10x1	48,0	14	12	12,0	32,5
RP15986NIX	8/6	M12x1	50,0	17	14	12,0	46,5







# ACCESSORI INOX

STAINLESS STEEL ACCESSORIES

The standard fittings consist of those items useful to connect different components in order to complete all other fitting series.

The fittings of the series “accessories” are several, so it is impossible to define precise pressure values for each item.

The items here mentioned are manufactured upon request for minimum lots of 100 pieces. As for dimension make reference to the pamphlet of our catalogue “Touch, compression and accessory fittings” to the paragraph “Standard fittings and Accessories”. Others typologies about the same paragraph should be supplied by request.

M254X



M255X



RM200X



RC254X



PG260X



DE120X



La raccorderia “standard” è composta da tutti quegli articoli che servono a collegare fra di loro componenti di vario genere e fungono da completamento a tutte le altre serie di raccordi.

I raccordi della serie “Accessori” sono di tanti tipi e genere, pertanto risulta impossibile definire dei valori di pressione precisi per singolo articolo.

Gli articoli sotto riportati vengono prodotti a richiesta per lotti minimi di 100 pezzi, per le dimensioni fare riferimento al fascicolo del nostro catalogo “Raccordi a calzamento, a compressione e accessori” al paragrafo “Raccordi standard e Accessori”. Altre tipologie del medesimo paragrafo possono essere fornite a richiesta.

NC260X



NR261X



E261X



E265X



E100X



E200X



Al Fine di migliorare il contenuto tecnico dei prodotti, ci riserviamo la facoltà di modi ca senza alcun preavviso. Le dimensioni sono fornite solamente a titolo indicativo.

In order to improve the technical content of the products, we reserve the faculty of any modi cation without notice. The dimension are supplied as indication.



via Scandolare  
36040 Salcedo (VI) Italy

T +39 0445 300499  
F +39 0445 300205

E [info@unicnet.com](mailto:info@unicnet.com)  
I [www.unicnet.com](http://www.unicnet.com)



V41112018PM