

VALVOLE DI NON RITORNO E A SFERA

NON RETURN & BALL VALVES

The non return valve allows the free air flow from the supply to its application and prevents the return of flow to the supply. It is usually used as safety device, as it allows pressure to be maintained while unloading the supply.



Standard supply	Thread from 1/8 to 1/2
Material	Brass body and Shutter CW614N O-ring in Viton Spring made of AISI 302 steel
Use temperature	-18°C +70°C
Pressure	min 0,5 bar max 8 bar
Use	Air - Gas

La valvola di non ritorno permette il libero flusso dell'aria, dall'alimentazione all'utilizzo e impedisce il ritorno della stessa verso l'alimentazione.

Vengono generalmente impiegate come elementi di sicurezza in quanto permettono di mantenere in pressione una parte dell'impianto pur scaricando l'alimentazione.



Filetto da 1/8 a 1/2

Disponibilità standard

Corpo e otturatore in Ottone CW614N
O-ring in Viton
Molla in acciaio AISI 302

Materiali

-18°C +70°C

Temperatura di utilizzo

min 0,5 bar
max 8 bar

Pressione di utilizzo

Aria compressa - Gas inerti

Impiego

Valvola di non ritorno femmina-femmina Female-female no return valve

Code	F	CH	P	L	Gr.
VNR100M5NI	M5	8	5,5	26,5	14,0
VNR10018NI	1/8	13	8,5	35,5	26,0
VNR10014NI	1/4	17	11,0	42,5	37,8
VNR10038NI	3/8	24	12,0	58,0	72,6
VNR10012NI	1/2	24	15,0	64,0	120,8

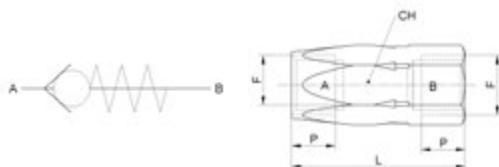

Valvola di non ritorno maschio-femmina Male-female no return valve

Code	F	CH	P	L	Gr.
VNR20018NI	1/8	14	12,0	53,0	59,0
VNR20014NI	1/4	17	17,0	66,0	103,4
VNR20012NI	1/2	27	20,0	81,0	246,6
VNR200M5NI	M5	8	5,5	26,5	14
VNR20038NI	3/8	24	12,0	58,0	72,6

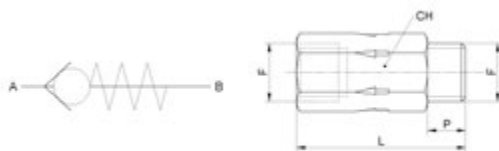

The Mini and Micro ball valves are shutoff valves type ON - OFF.

The opening and closing valve work manually through the lever.

The Micro series have been created for applications with limited spaces



Standard Supply	Thread from 1/8 to 3/4
Material	Brass body and ball CW614N O-ring Nbr 70 PTFE Seal Lever Nylon 66 glass
Use temperature	-25°C +90°C
Use pressure	min 0 bar max 10 bar
Use	Air - Gas - Water - Oils

Le Mini e Micro valvole a sfera sono valvole di intercettazione del tipo ON-OFF. L'apertura e la chiusura della valvola avvengono manualmente mediante l'apposita leva. La serie Micro è stata studiata per le applicazioni che necessitano di ingombri ridotti.



Filetto da 1/8 a 3/4

Disponibilità standard

Corpo e sfera in Ottone CW614N
O-ring in Nbr70
Guarnizioni in PTFE
Leva in nylon 66 caricato vetro

Materiali

-25°C +90°C

Temperatura di utilizzo

min 0 bar
max 10 bar

Pressione di utilizzo

Aria compressa - Gas - Acqua - Oli

Impiego

Mini valvola a sfera femmina-femmina
Female-female mini ball valve



Code	F	CH	P	L	A	H	Gr.
MVS40018FF	1/8	20	9,0	39,0	8,0	14,0	93,0
MVS40014FF	1/4	20	9,0	39,0	8,0	14,0	93,0
MVS40038FF	3/8	20	12,0	42,0	8,0	14,0	85,0
MVS40012FF	1/2	24	12,5	47,0	10,0	16,0	127,5
MVS40034FF	3/4	30	14,5	54,0	12,0	19,0	195,0

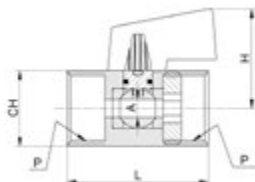

Mini valvola a sfera maschio-femmina
Male-female mini ball valve



Code	F	CH	P	P1	L	A	H	Gr.
MVS40518MF	1/8	20	8,0	10,5	39,0	8,0	28,0	80,5
MVS40514MF	1/4	20	9,0	10,5	39,0	8,0	28,0	78,0
MVS40538MF	3/8	20	10,0	10,0	40,0	8,0	28,0	74,0
MVS40512MF	1/2	24	12,0	10,5	45,0	10,0	30,0	122,0
MVS40534MF	3/4	30	14,0	12,0	51,0	12,0	32,0	180,0

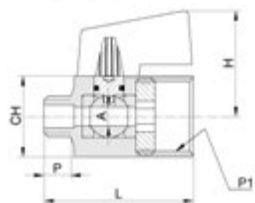

Mini valvola a sfera maschio-maschio
Male-male mini ball valve



Code	F	CH	P	L	A	H	Gr.
MVS41014MM	1/4	20	9,0	40,5	8,0	28,0	69,0
MVS41038MM	3/8	20	10,0	42,5	8,0	28,0	71,0
MVS41012MM	1/2	24	11,0	50,0	10,0	30,0	117,0

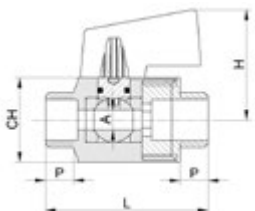

Micro valvola a sfera femmina-femmina
Female-female micro ball valve

Code	F	CH	P	L	A	H	Gr.
MCVS100018FF	1/8	15	8,0	34,0	5,5	21,5	35,0
MCVS100014FF	1/4	15	11,0	39,0	5,5	21,5	40,0
MCVS100038FF	3/8	17	11,5	43,0	7,0	22,5	
MCVS100012FF	1/2	21	16,0	49,0	10,0	32,0	

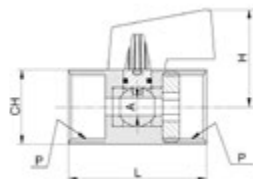

Micro valvola a sfera maschio-femmina
Male-female micro ball valve

Code	F	CH	P	P1	L	A	H	Gr.
MCVS110018MF	1/8	15	8,0	8,0	34,0	5,5	21,5	34,0
MCVS110014MF	1/4	15	11,0	11,0	39,0	5,5	21,5	40,0
MCVS110038MF	3/8	17	13,0	16,0	43,0	7,0	22,5	
MCVS110012MF	1/2	21	17,0	23,0	49,0	10,0	32,0	

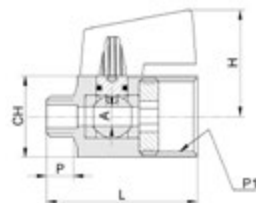

Micro valvola a sfera maschio-maschio
Male-male micro ball valve

Code	F	CH	P	L	A	H	Gr.
MCVS120018MM	1/8	15	8,0	33,0	5,5	21,5	31,0
MCVS120014MM	1/4	15	11,0	36,0	5,5	21,5	36,0
MCVS120038MM	3/8	17	13,0	45,0	7,0	22,5	
MCVS120012MM	1/4	21	17,0	48,0	10,0	32,0	

